

Beschichtung (Standard):

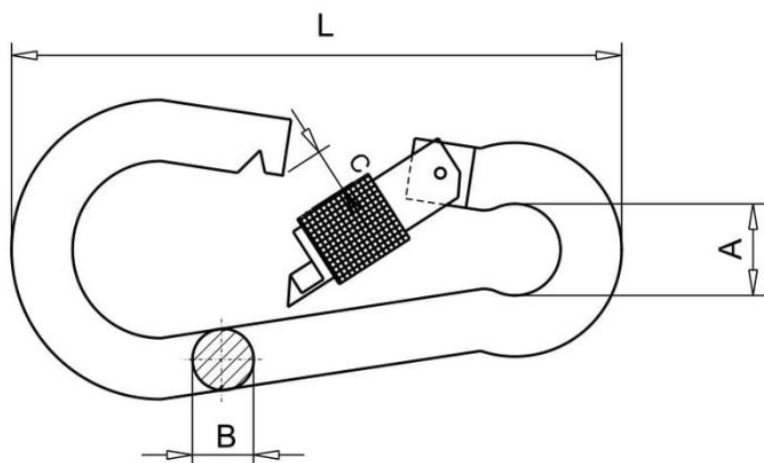

Maße

Material index	Typ	A [mm]	B [mm]	C [mm]	L [mm]	Obciążenie znamionowe [kg]	Obciążenie zrywające [kg]
6324080080S	8x80	11.5	7.4	8	80	230	460
6324070070S	7x70	10	6.7	7.5	70	180	360
6324060060S	6x60	8.5	5.5	6	60	120	240
6324050050S	5x50	7.5	4.8	5	50	100	200
6324040040S	4x40	6	3.9	4	40	70	140
6324120140S	12x120	20	11.5	20	140	450	900
6324110120S	11x120	17.5	10.7	15	120	400	800
6324100100S	10x100	14.5	9.4	10	100	350	700